

County: 17 Harrison District: 14 Map: 244 Parcel: 23 SubParcel: 1 Tax Year: 2019 Date: 5/14/2020

List Name	Dist	Map	Parcel	Owner	Care of	Address	Loc	Book	Page	Legal Desc	Class	Account	Sale Date	Apr Min	Apr Land	Apr Build	Apr Total	Prop Tax
SARDIS-OUTSIDE DISTRICT	14	244	23.1	DOWNS THOMAS H & REBECCA D(KENNETH JOHN BOYLES JR ETUX)		530 FLAG RUN RD, CLARKSBURG, WV26301	530 FLAG RUN RD	1557	307	17.10 AC FLAG RUN	2	6570294	26- jun- 2015		\$37,600	\$87,200	\$124,800	\$863.8

First | Previous | 1 | Next | Last

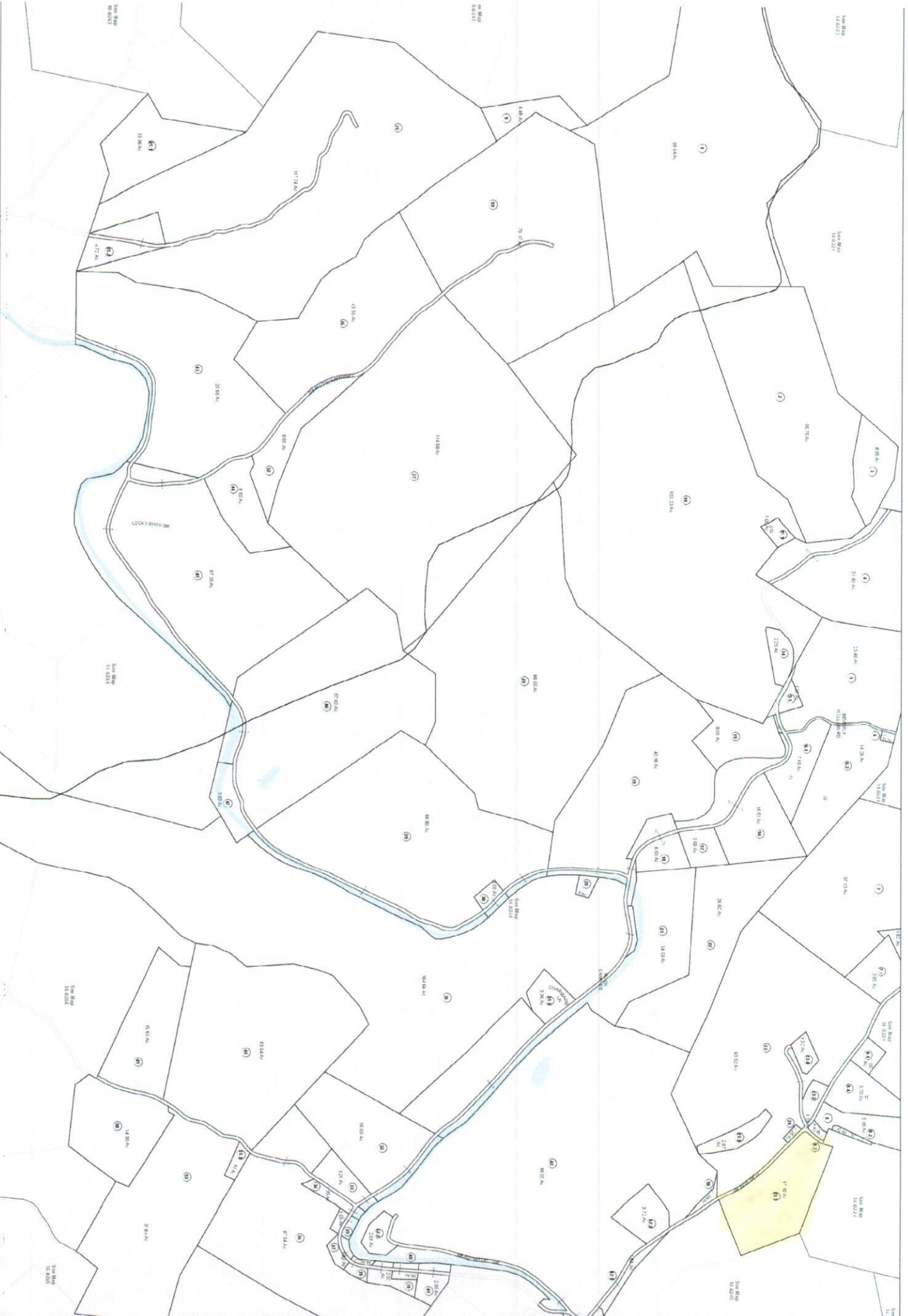

FOR TAX PURPOSES ONLY
 Prepared By:
Joseph R. Romano
 Harrison County Assessor

Property Use:
 Edge of Forest or Orchard
 District:
 2499 LHM

Legend

Copy of Law:
 Date of Review (or Amendment):
 Parcel ID Number:
 Revised:
 View:

Legend

Notes:
 All tax maps created under the authority of
 the Board of Assessors of Harrison County, West Virginia and the preparation
 of this map is subject to the provisions of the West Virginia Code and the
 provisions of the Harrison County Assessor's Ordinance as
 amended by law.



HARRISON COUNTY - WEST VIRGINIA
 Office of Assessor

District: Sards District &
 Map No: 14-024
 Date: January 1, 2017
 Scale: 1 inch = 400 feet